

Exhibit A2 San Ramon Center Speakers = 27 / Buttons = 27

**NOTE: All buttons to be installed at ADA height
(between 36 to 48 inches from the floor)**

KEY

- – Both speaker and button in same location (special instructions will be noted below)

S – Speaker

B – Button

X – Location “tentative”

Patch Panel/IDF - marked in **RED**

SAN RAMON VALLEY CENTER FIRST FLOOR

(105 WB-2-1)

101 – speaker replaces clock; button below

(189? EB-1-1)

160 – speaker above; button below

161 – speaker above; button below

162 – speaker to left of door; button below

164 – speaker above; button below

168 – speaker above; button below

174 – speaker above; button below

176 – speaker above; button below

181 – speaker above; button below

183 – speaker above; button below

188 – speaker above; button below

SAN RAMON VALLEY CENTER SECOND FLOOR

(202 WB-2-1)

216 – speaker above; button below

217 – speaker above; button below

218 – speaker above; button below

219 – speaker above; button below

220 – speaker above; button below

221 – speaker above; button below

222 – speaker above; button below

(233 EB-2-1)

225 – speaker above; button below

226 – speaker above; button below

229 – speaker above; button below

232 – speaker above; button below

235 – speaker above; button below

237 – speaker above; button below

238 – **S** speaker above door; **B** button below

240 – speaker above; button below

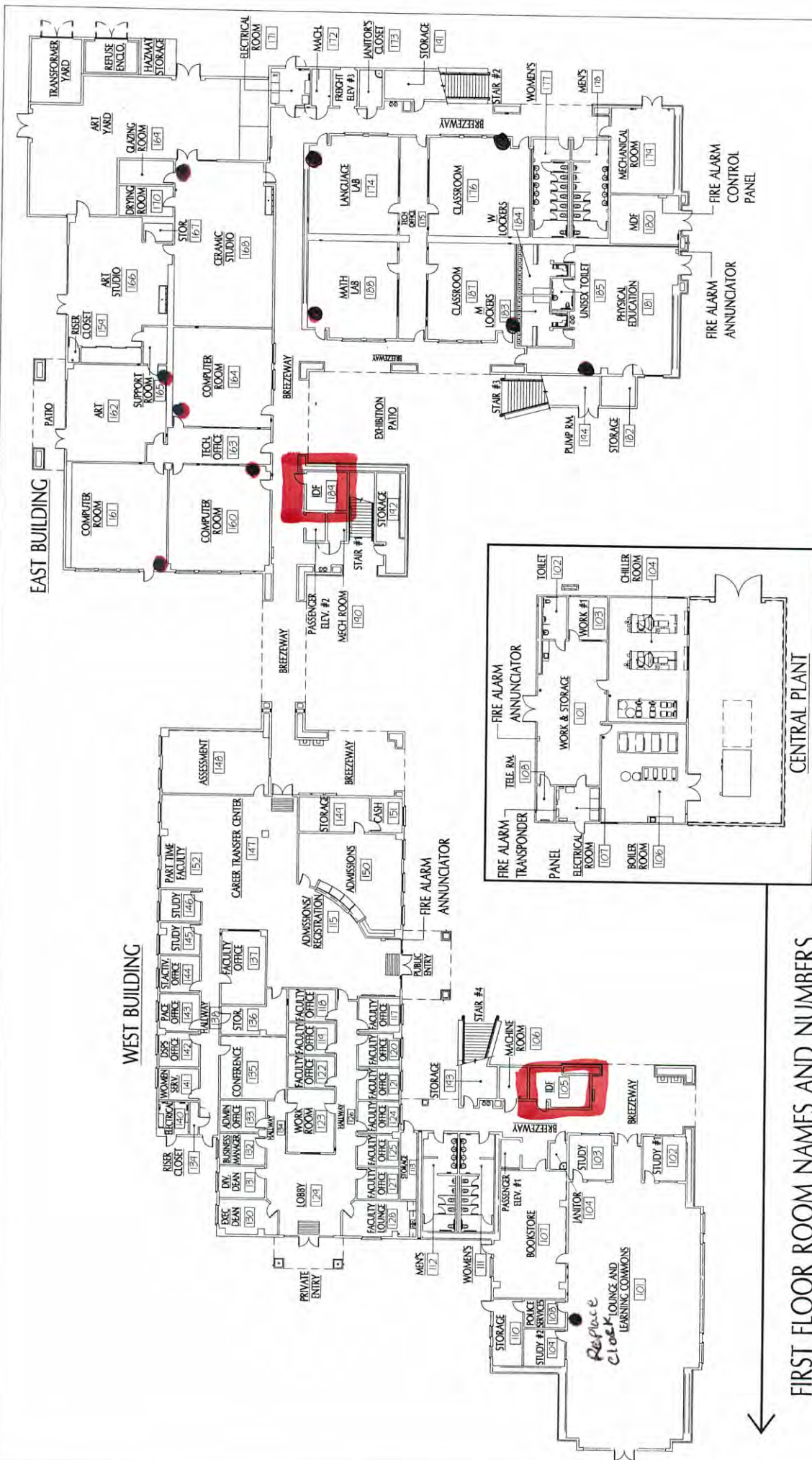

FIRST FLOOR ROOM NAMES AND NUMBERS

SAN RAMON VALLEY CENTER

Contra Costa Community College District

- Buttons Below Speaker at ADA Height



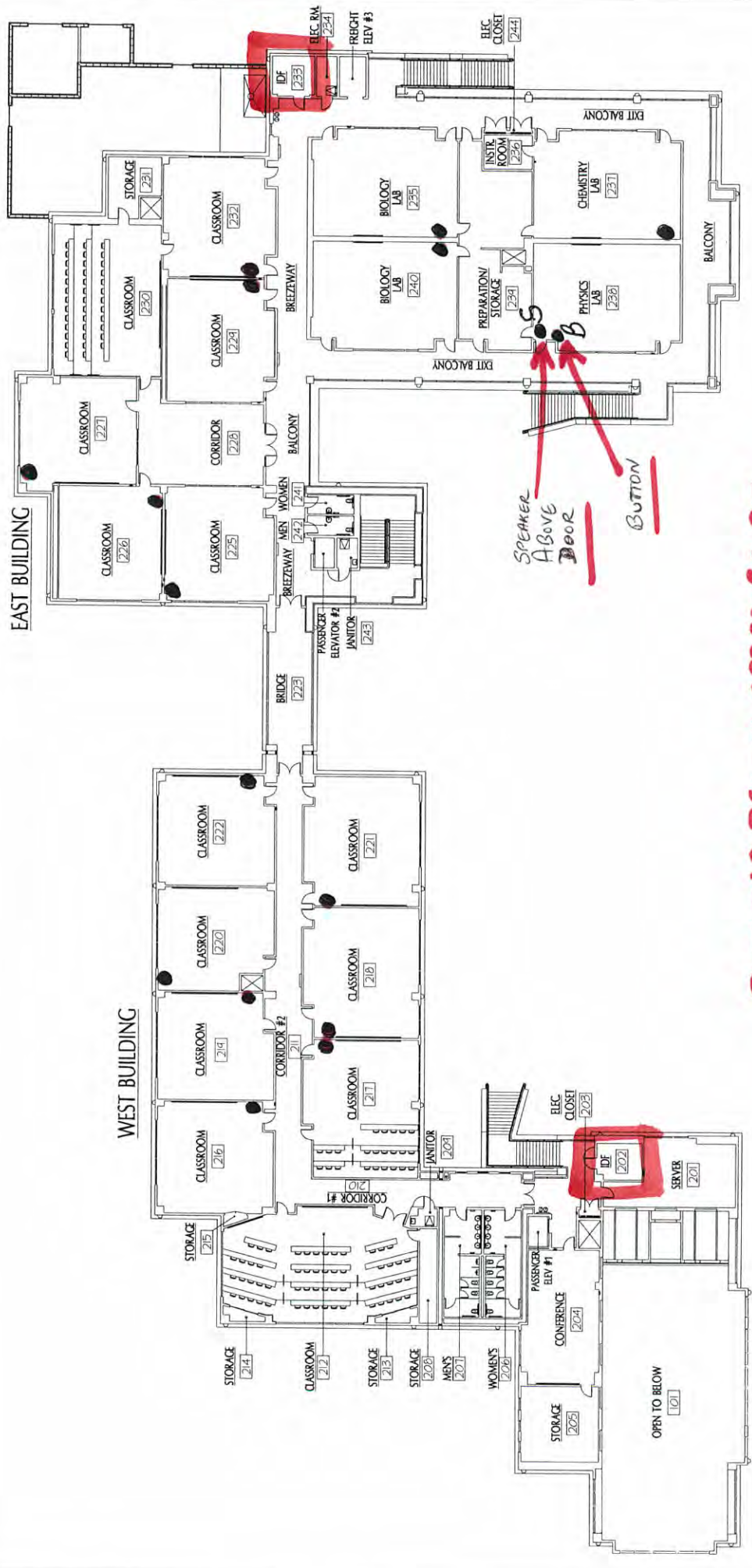

**Buttons Below Speaker AT
AT ADA Height Except in Am. 238**

SECOND FLOOR ROOM NAMES AND NUMBERS

SAN RAMON VALLEY CENTER

Contra Costa Community College District

